

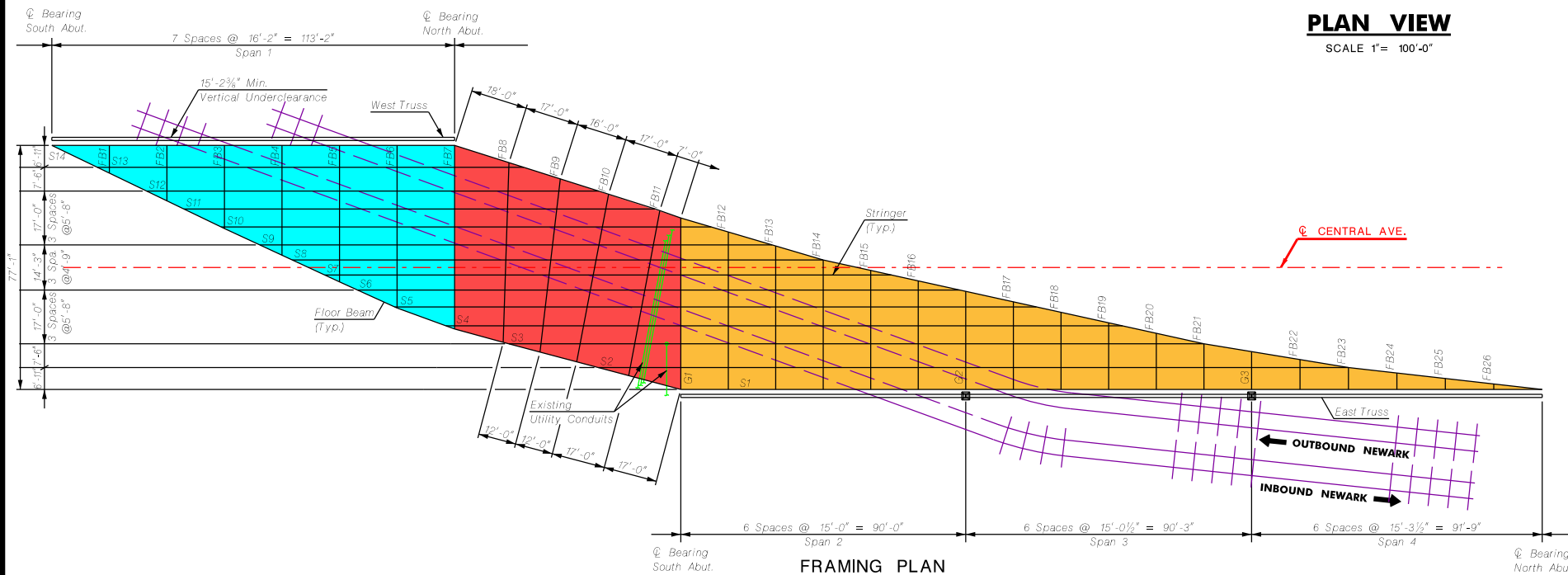

**PLAN VIEW**

SCALE 1" = 100'-0"



**FRAMING PLAN**

SCALE 1" = 20'-0"

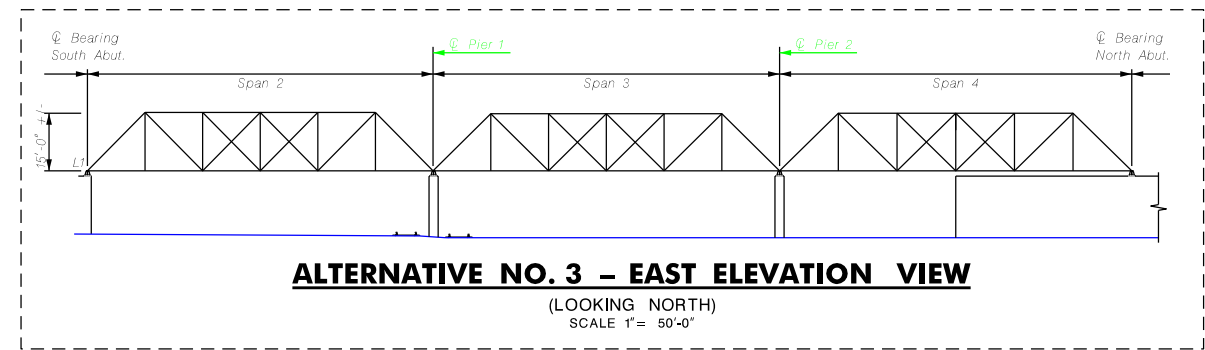

**ALTERNATIVE NO. 3 - EAST ELEVATION VIEW**

(LOOKING NORTH)  
SCALE 1" = 50'-0"

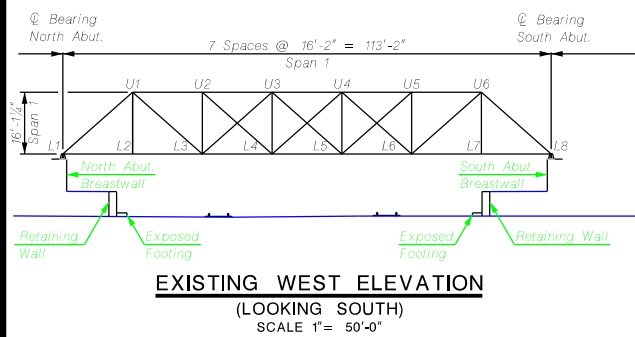

**EXISTING WEST ELEVATION**

(LOOKING SOUTH)  
SCALE 1" = 50'-0"

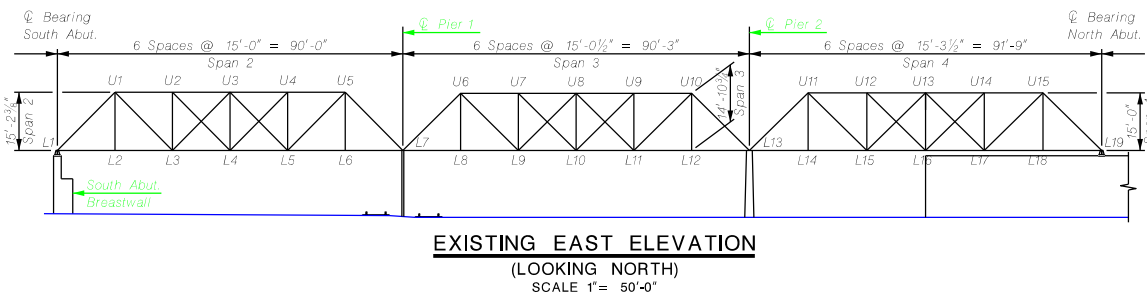

**EXISTING EAST ELEVATION**

(LOOKING NORTH)  
SCALE 1" = 50'-0"

**FULL REPLACEMENT**